

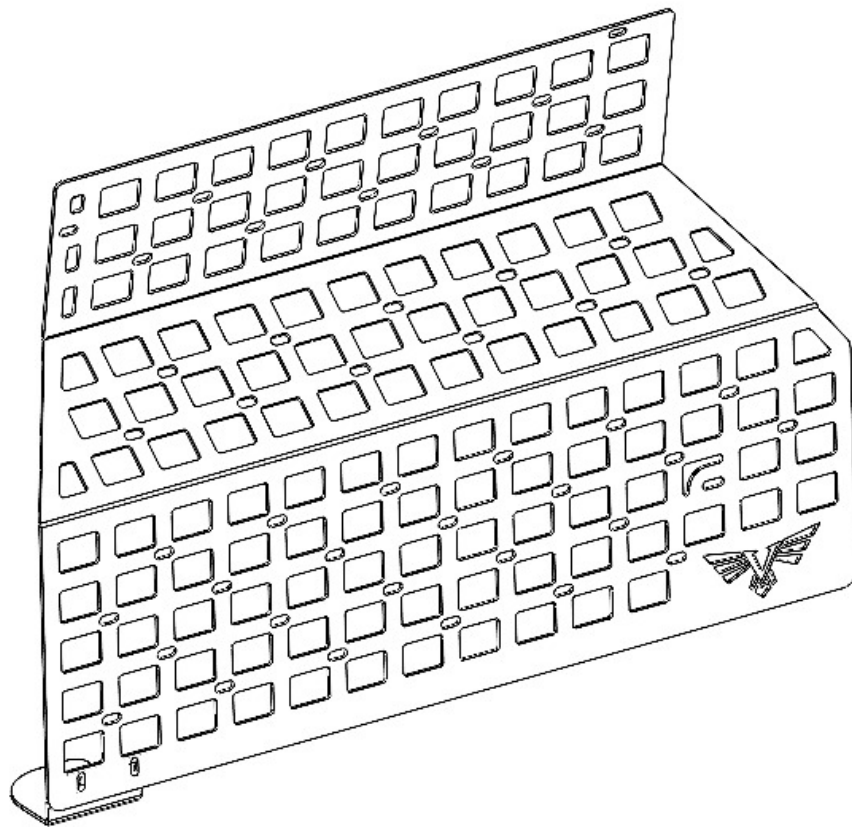

VICTORY 4X4

# 5TH GEN 4RUNNER REAR LOWER MOLLE PANEL

## INSTALL INSTRUCTIONS



**Please read the mounting instructions below carefully before attempting to install.**

**Check out the install video on the product page for factory rack disassembly.**

Thank you for purchasing from Victory 4x4! Checkout our website, [victory4x4.com](http://victory4x4.com) for other great off-road products. Be sure to rate and review our product online. If you have any questions or are missing parts, please don't hesitate to call us at 269-459-8447!

# INCLUDED HARDWARE

## INCLUDED BOLT PACK(S) 046-0158

Note: Some Victory 4x4/JCR Offroad/SquatchProof products share hardware kits. Any extra hardware you may receive that is not listed below can be repurposed or discarded.

4x

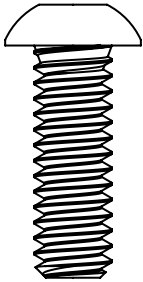

1/4"-20 X 3/4"  
Button Head

4x



18-8 M6 x55mm  
Button Head

1x

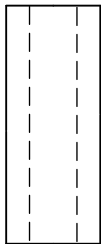

1/2" OD x 1-1/4" Long  
Off-White Spacer

4x

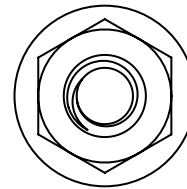

1/4"-20  
Flange Nut

2x

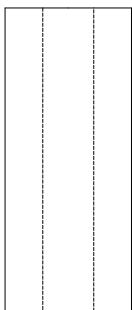

5/8" OD x 1-1/2" Long  
Off-White Spacer

1x

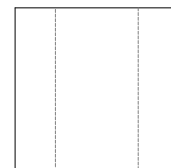

19mm x 10.2 ID  
25mm Long Spacer

# INCLUDED PARTS

1L or 1R

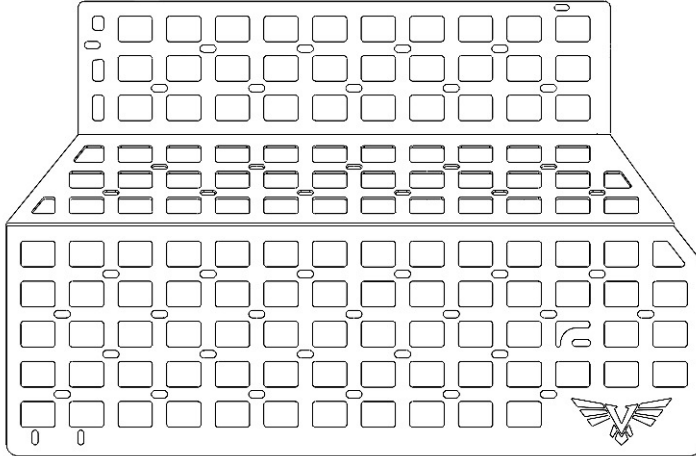

**Rear Lower Molle Panel**

1L or 1R

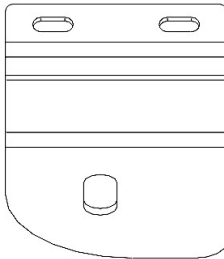

**Lower Bracket**

1L or 1R

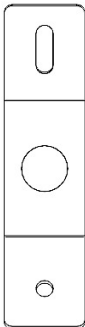

**Upper Bracket #1**

1L or 1R

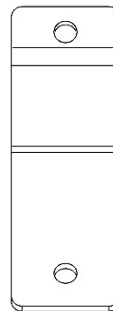

**Upper Bracket #2**

# ASSEMBLY

- 1.** If you already have a Victroy 4x4 Rear Window Molle Panel installed in your vehicle, then you can ignore the provided Upper Brackets #1,2 that came with your product. If you do not already have a Rear Window Molle Panel, then you will need to install the (2) provided brackets. Bracket #1 can be installed by removing the net tie down clip by rotating it 90 degrees, then use a 10mm socket to remove the factory bolt. Once removed, take the long M6 bolt and the 1-1/2" long white spacer and bolt it through the slotted side into the factory mounting hole, with the spacer behind. You can then place the net tie down back through the hole in the bracket.



# ASSEMBLY

2. Bracket #2 will be installed using the same hardware configuration, before you install there will be a plastic circle that needs to be removed in order to gain access to the factory threaded hole. When you install your bracket, ensure that the slot on the bracket is at the top before tightening down the hardware.



# ASSEMBLY

3. Next, you will need to install the Lower Bracket into the floor tie down location. To do this, pop the plastic cover off of the factory tie down hook with a flat screwdriver. Once popped up, remove the factory hex head with a 10mm socket, and remove the whole assembly. Once removed, take the provided aluminium spacer and place it over the factory threaded hole in the floor for the bracket to clamp over it. Once in place, take your Lower Bracket and the provided long M6 bolt with the factory hook that was removed, as shown below, and loosely bolt them down into place using the factory hole to clamp the hook, bracket and spacer together.





# ASSEMBLY

4. With the floor bracket loosely bolted in place, to be able to maintain some adjustability if needed, Take a flat screwdriver and pop the plastic cover off the factory threaded hole, as shown below. Once removed, take a 10mm socket and remove the factory bolt inside. Then, if you have the Rear Window Molle installed, you will need to remove the 1/4"-20 button heads at the bottom on the panel in order to secure the new Lower Molle to the same holes, as shown below.



# ASSEMBLY

5. Next, you will secure the Lower Molle to the Rear Window Molle and brackets (if installed), or just the brackets if you do not have a Rear Window Molle installed. Secure together using the (2) provided 1/4"-20 button heads and flange nuts, as shown in the orientation below.

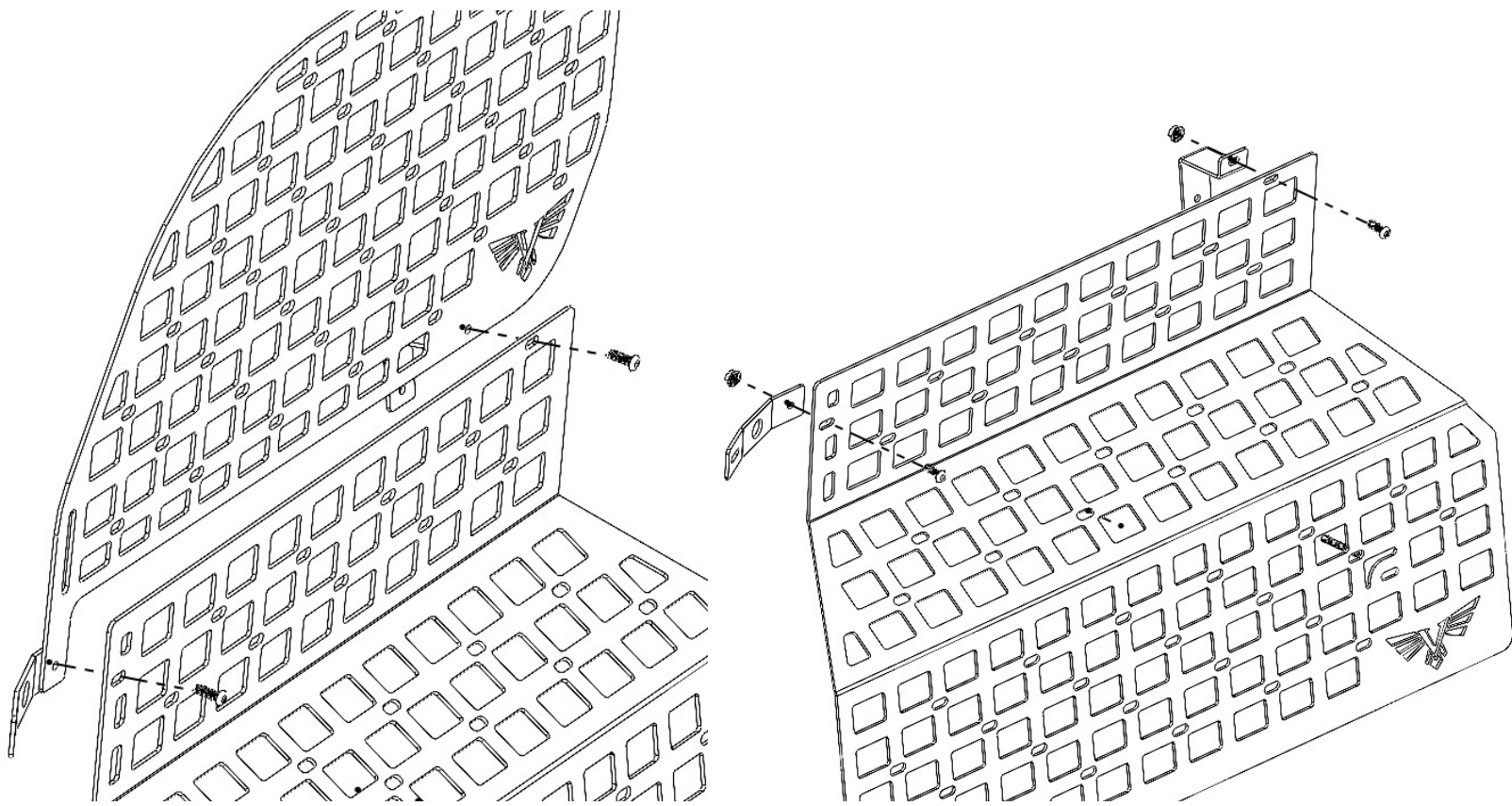



# ASSEMBLY

6. Once you have the top of the panel secure to the brackets, take the provided longer M6 button head and 1-1/4" long white spacer and use them to secure the panel into the factory threaded hole, with the spacer behind the panel, as shown in the orientation below.

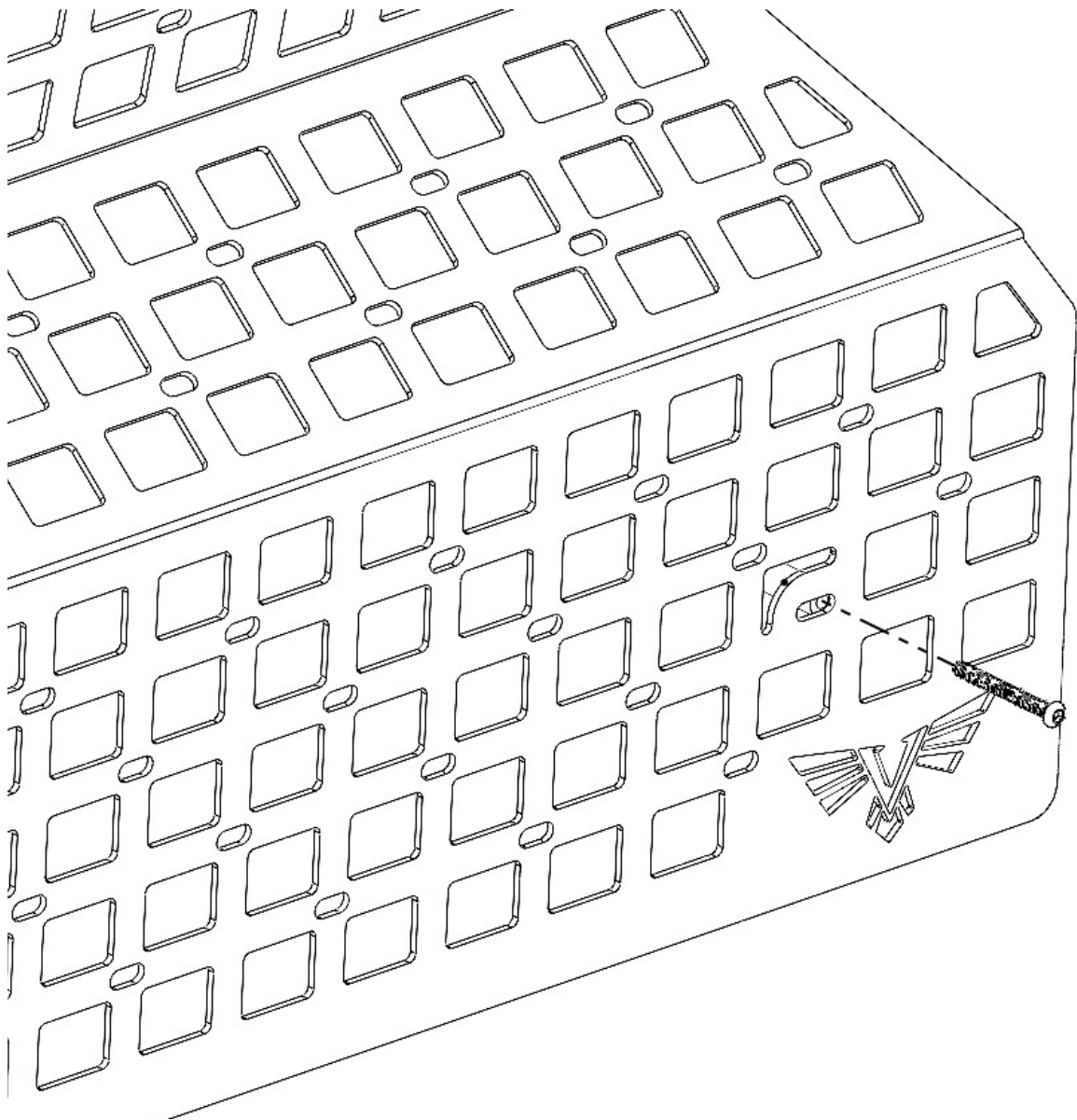

# ASSEMBLY

7. With the M6 bolt secured into the panel with a spacer, take (2) more of the provided 1/4"-20 button heads and flange nuts and secure the panel to the previously installed Lower Bracket, as shown in the orientation below.

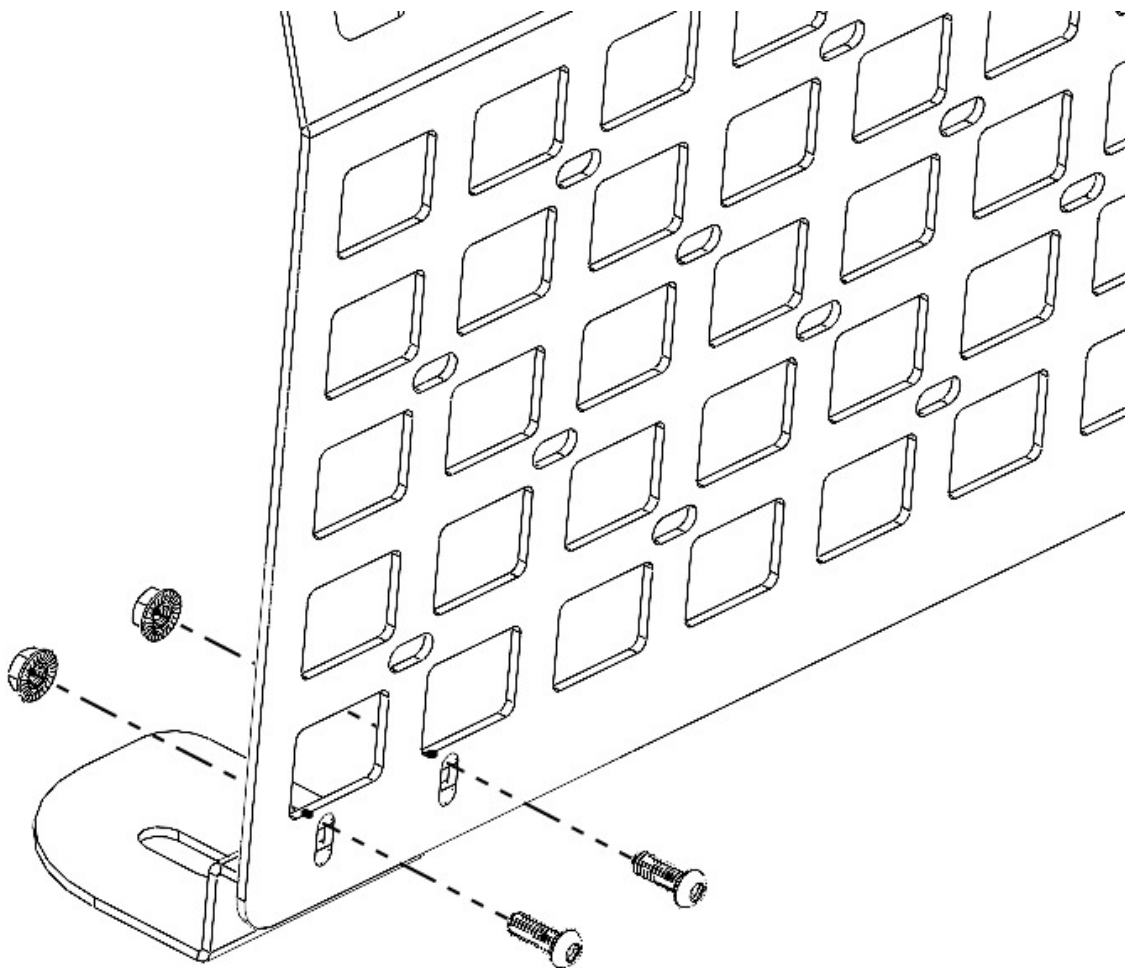

# ASSEMBLY

8. With all of the brackets and hardware in place, now is the time to adjust the horizontal adjustment if desired, before fully tightening down all of your hardware to complete your install. Be sure to go back and fully tighten down the Lower Bracket to the floor after securing the panel to it. You are now ready to strap and secure all of your gear in a handy and useful place before hitting the trails! Be sure to check out [Victory4x4.com](http://Victory4x4.com) for even more 4Runner products and convenient storage solutions.

