



VICTORY 4X4

LEXUS GX460 (2010+) INTERIOR

MOLLE PANEL

INSTALL INSTRUCTIONS

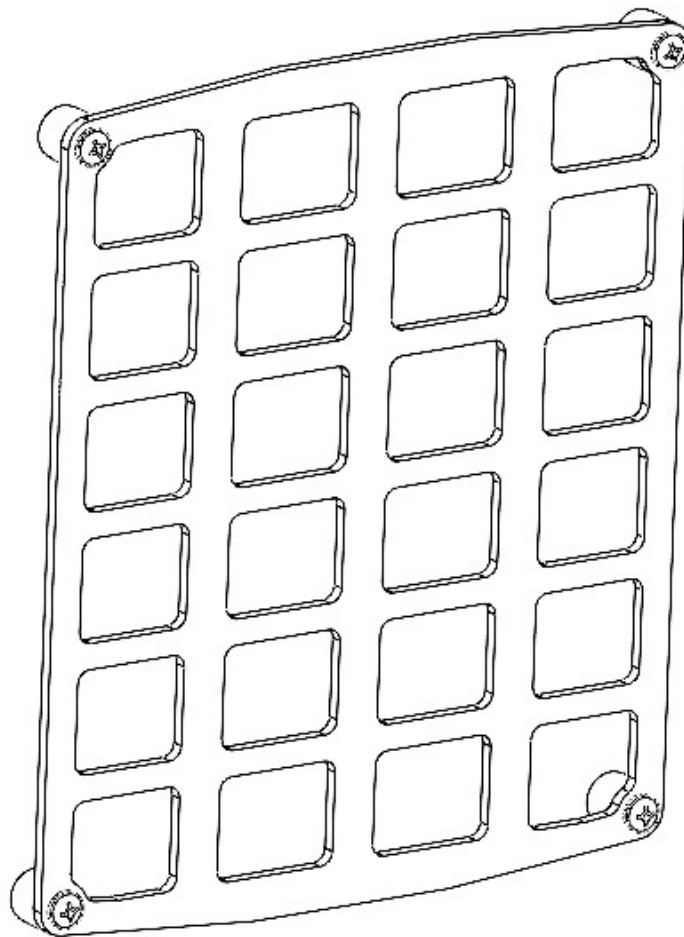

Please read the mounting instructions below carefully before attempting to install.

Be sure to check out the install video on the product page, if available.

Thank you for purchasing from Victory 4x4! Checkout our website, victory4x4.com for other great off-road products. Be sure to rate and review our product online. If you have any questions or are missing parts, please don't hesitate to call us at 269-459-8447!

INCLUDED HARDWARE

INCLUDED BOLT PACK(S) 046-0044

4x

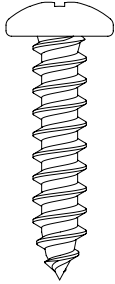

Black Philips Head
18-8 Stainless Steel
3/4" Long Screw

4x

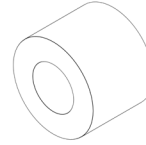

Black Nylon 1/2" OD
3/8" Long Spacer

Note: Some Victory 4x4/JCR Offroad/SquatchProof products share hardware kits. Any extra hardware you may receive that is not listed above can be reused or discarded.

INCLUDED PARTS

1x

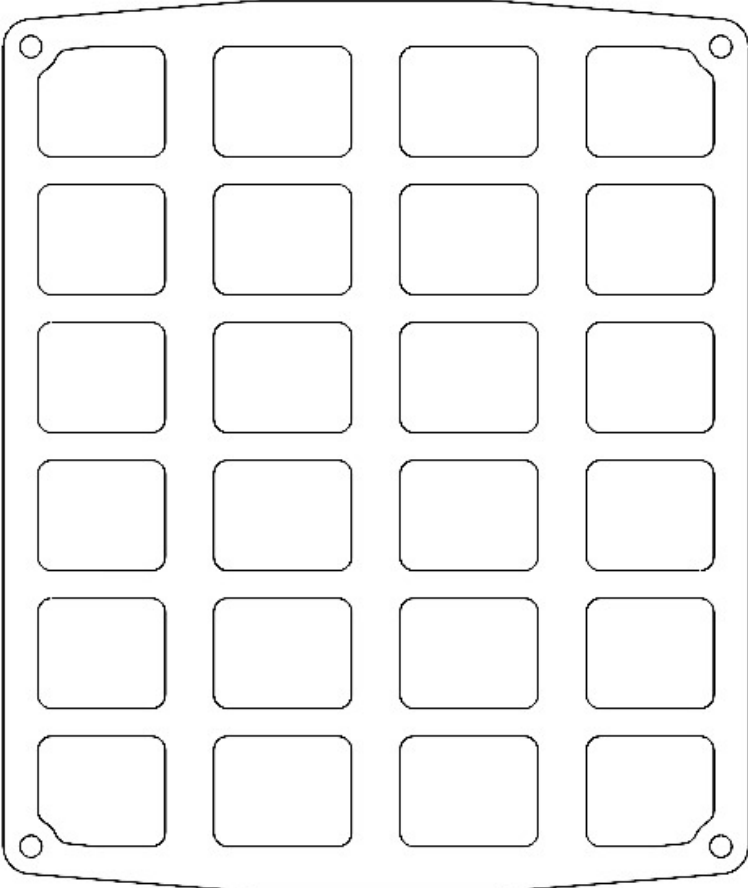

INSTALLATION

1. Start by lining up the panel up on the interior underside of your armrest, and center it visually to your liking, as shown below. When the panel is lined up to your liking, then take a punch or a philips head screw driver and apply pressure to mark the four smaller mounting holes in the plastic.



INSTALLATION

2. Once the pilot holes are marked, you can remove the panel. Take the provided screws and start to thread them into the locations just marked in the plastic. Make sure not to punch too far through the plastic. You can also use a drill with a 1/16" drill bit to start your holes, making sure not to punch through the plastic.
3. After the holes are started, place the panel back in line with the holes and place the provided spacers behind the panel, as shown below. You can then start to thread the screws into the plastic with a screw driver until all four are snug and the panel is secure, be sure not to over tighten.

